



PARTYBOX
ON-THE-GO2



WHAT'S IN THE BOX



*The plug type and the quantity of power cords, microphones, and microphone holders vary by regions.

BLUETOOTH PAIRING



PLAY



LIGHTSHOW



Apply lightshow presets and more with the JBL app.

APP

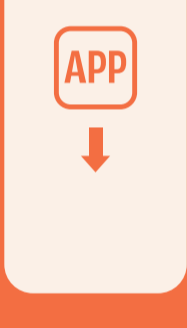

Download and install the JBL app to get more from the product.



MICROPHONE



MULTI-SPEAKER CONNECTION

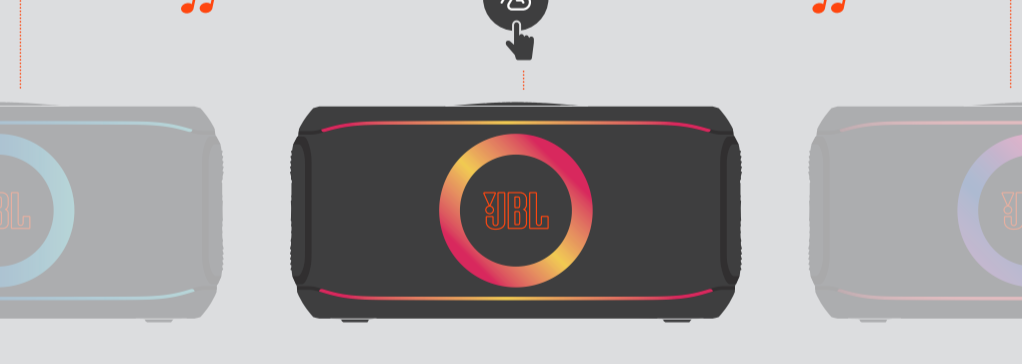
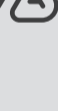

CHARGING



MICROPHONE HOLDER

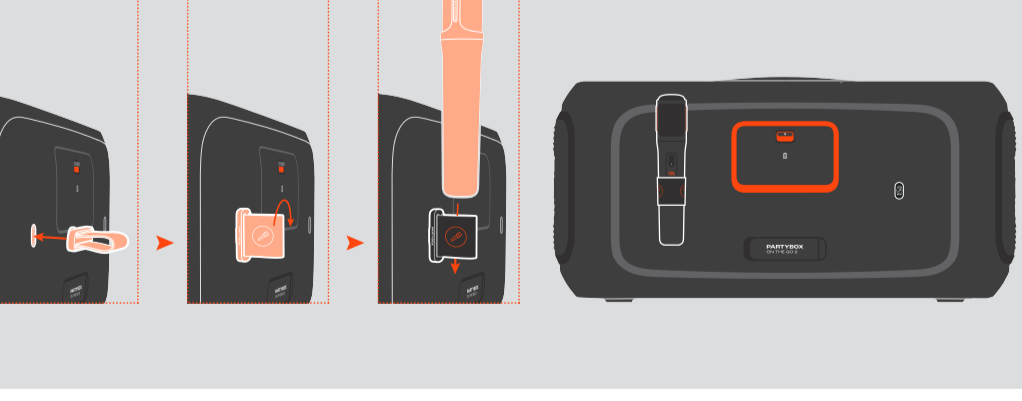

BATTERY REPLACEMENT

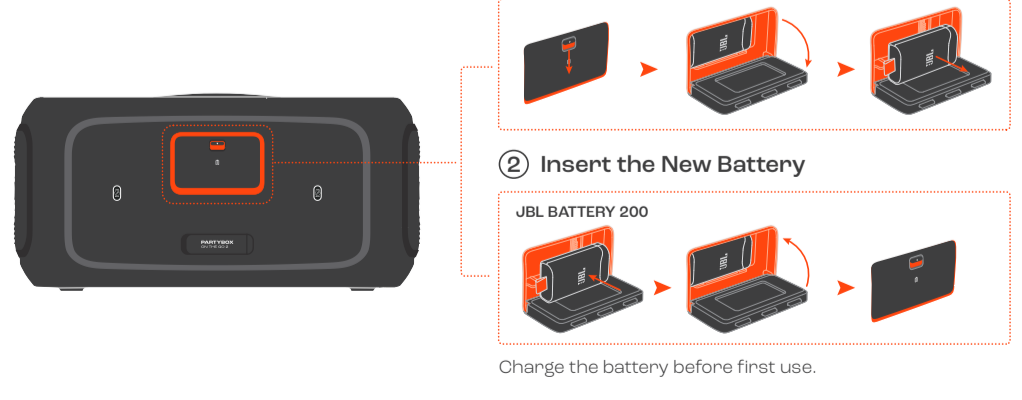

Change the battery before first use.

SPLASH PROOF IPX4

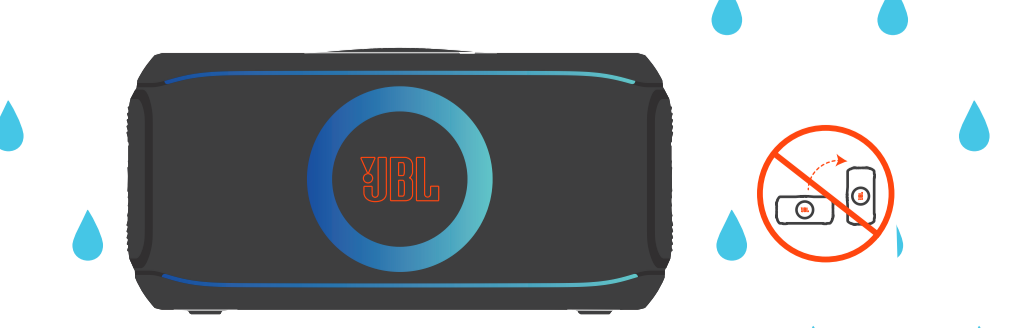

Do not charge your speaker until it is completely dry and clean.

